

Drawing Name: N:_Projects\031 - IR Horton\031.024 - Manor Creek Unit 5\031.024.111 - Revise Construction Drawings\Phase 5B\031.024.105_SITMA.dwg User: gornett Jul 26, 2016 - 8:33am

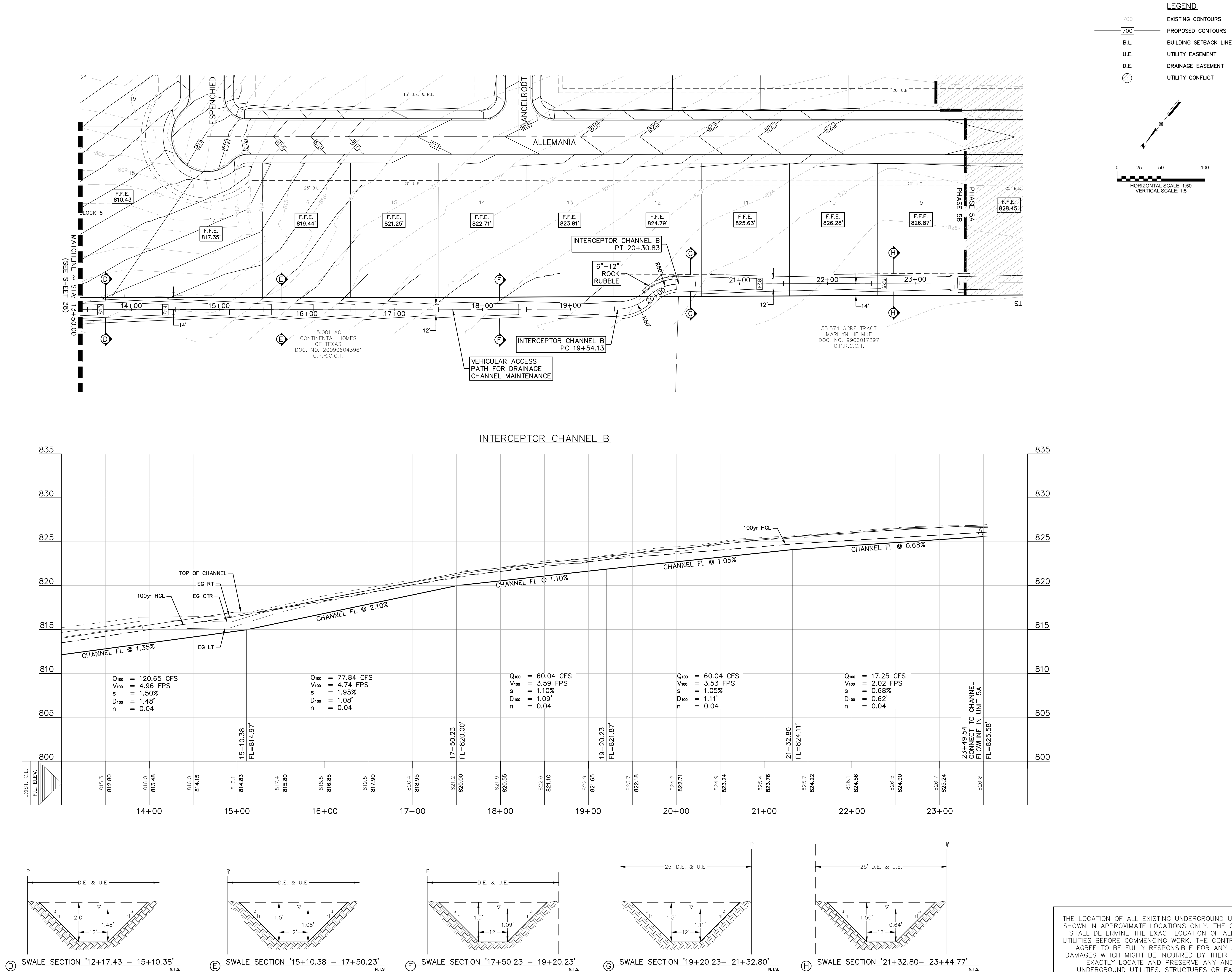

THE LOCATION OF ALL EXISTING UNDERGROUND UTILITIES ARE SHOWN IN APPROXIMATE LOCATIONS ONLY. THE CONTRACTOR SHALL DETERMINE THE EXACT LOCATION OF ALL EXISTING UTILITIES BEFORE COMMENCING WORK. THE CONTRACTOR WILL AGREE TO BE FULLY RESPONSIBLE FOR ANY AND ALL DAMAGES WHICH MIGHT BE INCURRED BY THEIR FAILURE TO EXACTLY LOCATE AND PRESERVE ANY AND ALL UNDERGROUND UTILITIES, STRUCTURES OR FACILITIES. CONTRACTOR SHALL NOTIFY ENGINEER OF ANY DISCREPANCIES 24-HOURS PRIOR TO COMMENCING CONSTRUCTION.

410 N. SEGUN AVE.
NEW BRAUNFELS, TX 78130
HMTNB.COM
P(830)625-8555 F(830)625-8556
TBPB FIRM F-10961
TBPB FIRM 10153600

HMT
ENGINEERING & SURVEYING

STATE OF TEXAS
CHRISTOPHER P. VAN HEERDEN
93047
LICENSED PROFESSIONAL ENGINEER
Chris Van Heerden, P.E.

7/05/16

INTERCEPTOR CHANNEL B (2 OF 2)

CIVIL SITE CONSTRUCTION PLANS

MANOR CREEK SUBDIVISION
UNIT 5B

DR HORTON
210 W. HUTCHISON
SAN MARCOS, TEXAS 78666

DATE: FEBRUARY 2016
DRAWN BY: TAB
DESIGNED BY: GJM
CHECKED BY: CVH
REVIEWED BY: SMH
PROJECT NO.: 031.024.105

SHEET 39